



## FOAMGLAS® Green Compact Roof

### Swarovski Group, Wattens

**Art director** Andre Heller

**Architect** Mag. Carmen Wiederin and Propeller Z, Vienna Ing. Georg Malojer, Project Management GmbH & Co, Innsbruck

**Built** 1995 / 2003 / 2007

**FOAMGLAS® application:** Roof insulation, about 5200 m<sup>2</sup> of FOAMGLAS® T4+ slabs in hot bitumen, 100 mm thick

**Roof finish** Intensive greening system

As with the first building of the enchanting Swarovski Crystal Worlds, FOAMGLAS® insulation systems were chosen for its extension. "Crystal Worlds" – an underground building – was designed with a most demanding roof structure. A critical concern was the replacement and the repair work on green roofs of this kind of scale, as they could be very costly and disrupt operating functions. The most impor-

tant characteristics that were required consisted in a constant, high level, thermal insulation efficiency and a total waterproofness. The high compressive strength of the insulation was an additional reason for selecting FOAMGLAS®. The roof has to bear considerable soil pressure, since the filled ground topping the roof structure is metres thick.

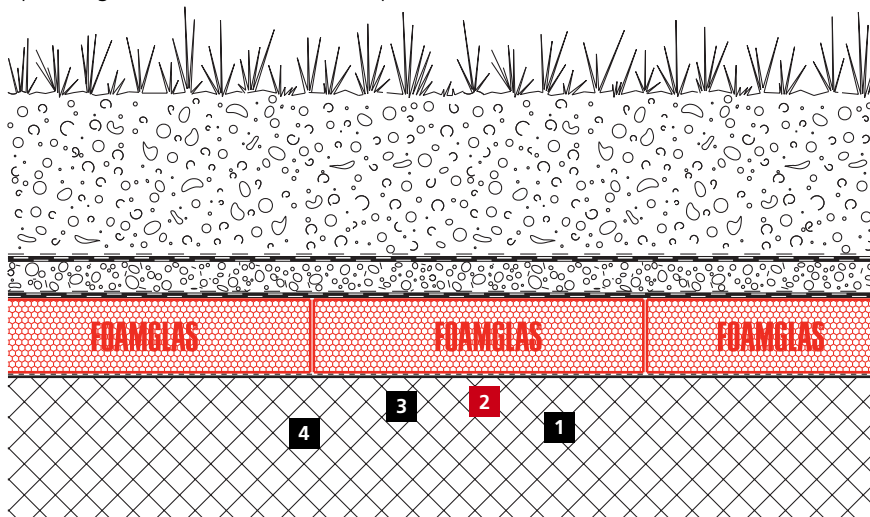

### FOAMGLAS® Compact Roof – double security to prevent water ingress

[www.foamglas.com](http://www.foamglas.com)

#### Roof structure

- 1 Concrete deck
- 2 Bituminous primer coat
- 3 FOAMGLAS® T4+ slabs, 100 mm thick, in hot bitumen
- 4 Bituminous waterproofing membranes, 2 layers
- 5 Protective layer, fleece
- 6 Drainage layer
- 7 Separating layer, fleece
- 8 Intensive greening system

